



OIL & GAS ASSET  
**CLEARINGHOUSE**

Established in 1992  
Re-Established 2019

Lockmar Resources, LLC

---

**STACK/SCOOP Leasehold Acquisition Opportunity  
Multiple Oklahoma Counties**

**COMPREHENSIVE A&D SERVICES FOR THE OIL & GAS INDUSTRY**

**[WWW.OGCLEARINHOUSE.COM](http://WWW.OGCLEARINHOUSE.COM)**

# Lockmar Resources, LLC

The Oil & Gas Asset Clearinghouse is partnering with Lockmar Resources, LLC to market 1,493.68 net leasehold acres in SCOOP/STACK plays. Lockmar Resources will accept offers for individual Lot or a group of Lots.

## SCOOP

Group	Location	Total NMA
A	North Grady and Caddo	117.43
B	West Grady	303.17
C	McClain and Cleveland	48.77
D	McClain and Garvin	198.72
E	Stephens	48.30

## STACK

Group	Location	Total NMA
F	West Dewey	348.12
G	East Dewey	347.01
H	Custer	7.54
I	Blaine	40.25
J	Major	32.34

# Lockmar Resources, LLC

## SCOOP Leasehold Acreage Grady, Caddo, McClain, Cleveland, Garvin, Stephens counties in Oklahoma

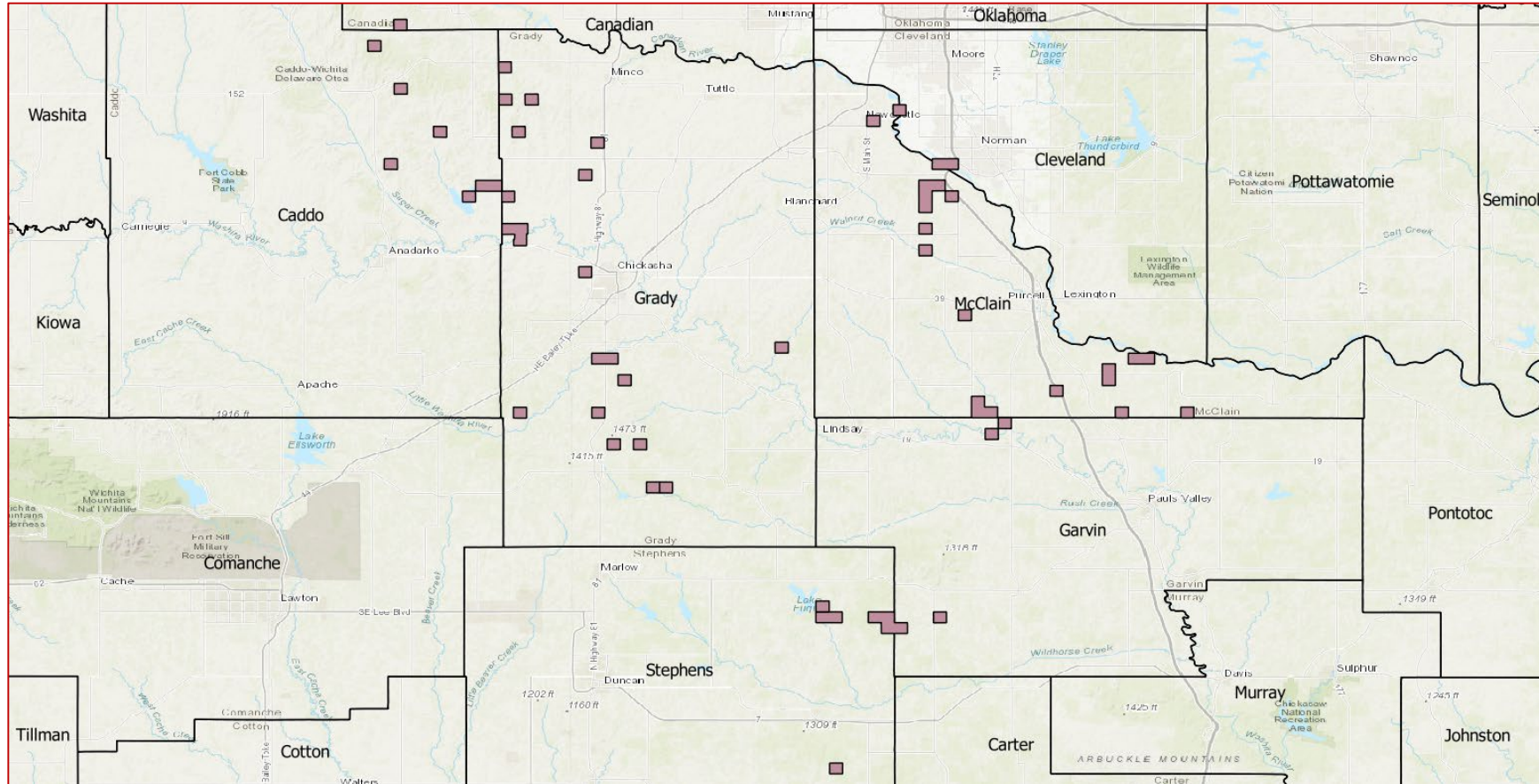

- 718.42 Net Mineral Acres
- Multiple targeted reservoirs - Mississippian, Woodford, Hunton
- Offset operators in the area include Chesapeake, Chevron, Anadarko, EOG, Exxon, Samson Resources

# Lockmar Resources, LLC

## STACK Leasehold Acreage Dewey, Custer, Blaine, Major counties in Oklahoma

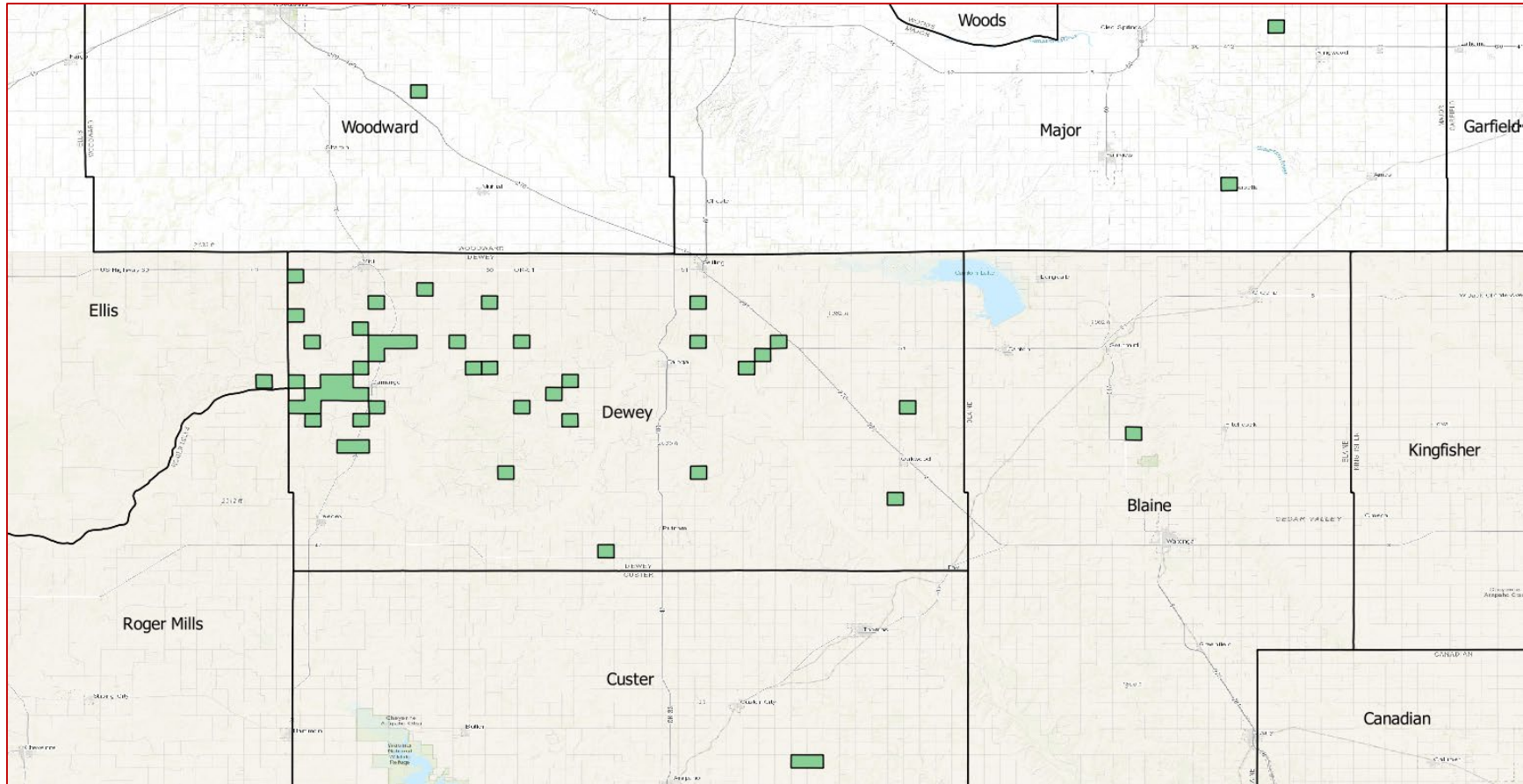

- 775.26 Net Mineral Acres
- Multiple targeted reservoirs – Red Fork, Mississippian, Woodford, Hunton
- Offset operators in the vicinity include EnCana, Noble Energy, Marathon, Devon, BP, Anadarko



# Lockmar Resources, LLC

Caddo, Grady, Canadian Counties, Oklahoma

The Oil & Gas Asset Clearinghouse is partnering with Lockmar Resources, LLC to market leasehold acreage in Caddo, Grady, and Canadian Counties, Oklahoma. Majority of leases with 80% NRI (minimum 75%)

## Group A Highlights

- 117.4 Total Net Mineral Acres
- Multiple targeted reservoirs-Mississippian, Woodford, Hunton
- Operators in the vicinity include Linn Energy, Continental Resources, Marathon

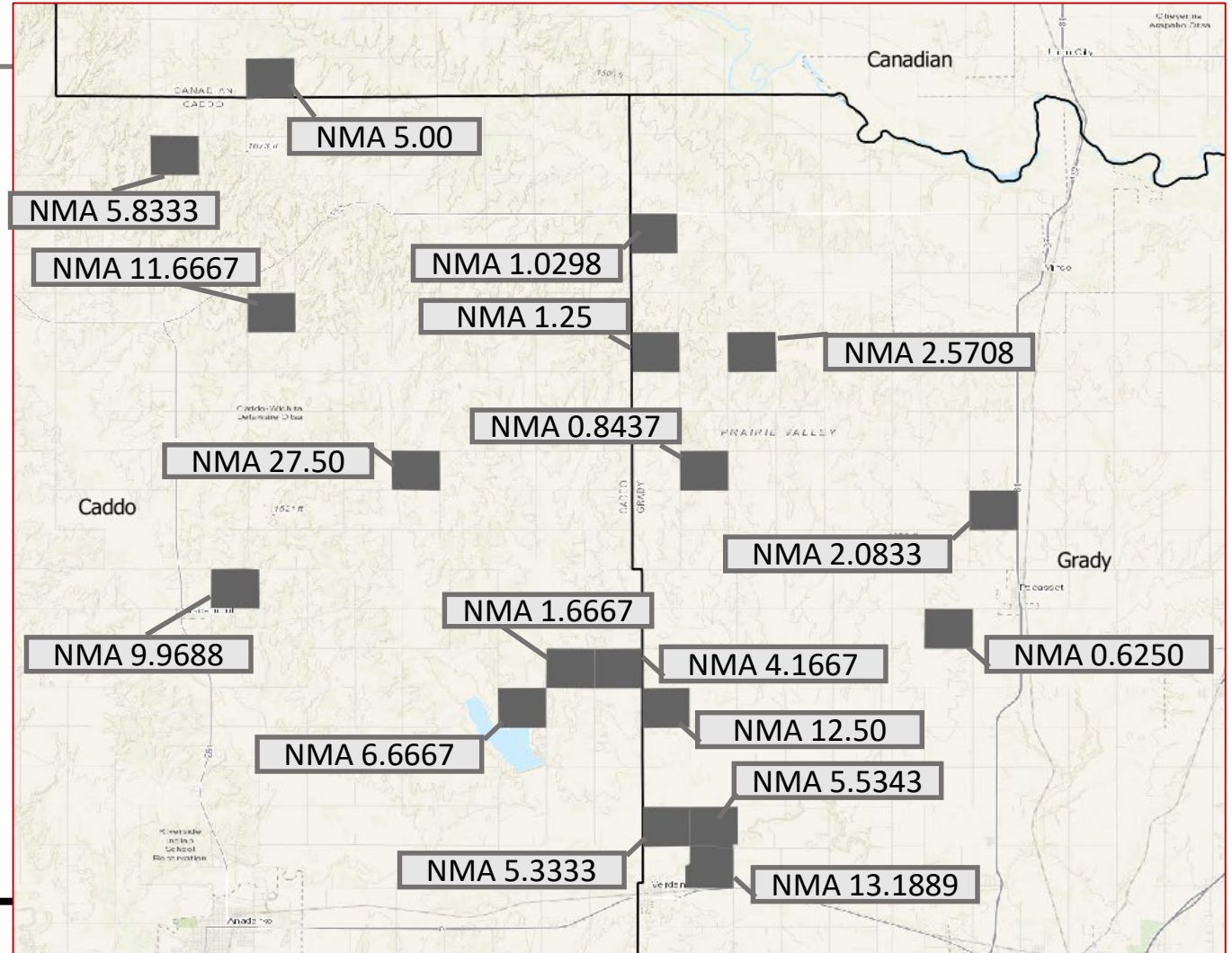

# Lockmar Resources, LLC

## Grady County Oklahoma

The Oil & Gas Asset Clearinghouse is partnering with Lockmar Resources, LLC to market leasehold acreage in Grady County, Oklahoma. Majority with 80 % NRI (minimum 78%)

### Group B Highlights

- 303.17 Total Net Mineral Acres
- Multiple targeted reservoirs-Mississippian, Woodford, Hunton
- Operators in the area: Anadarko Petroleum, Ward Petroleum, Chevron, Gulf Port Energy, Chesapeake Energy, GBK Corporation

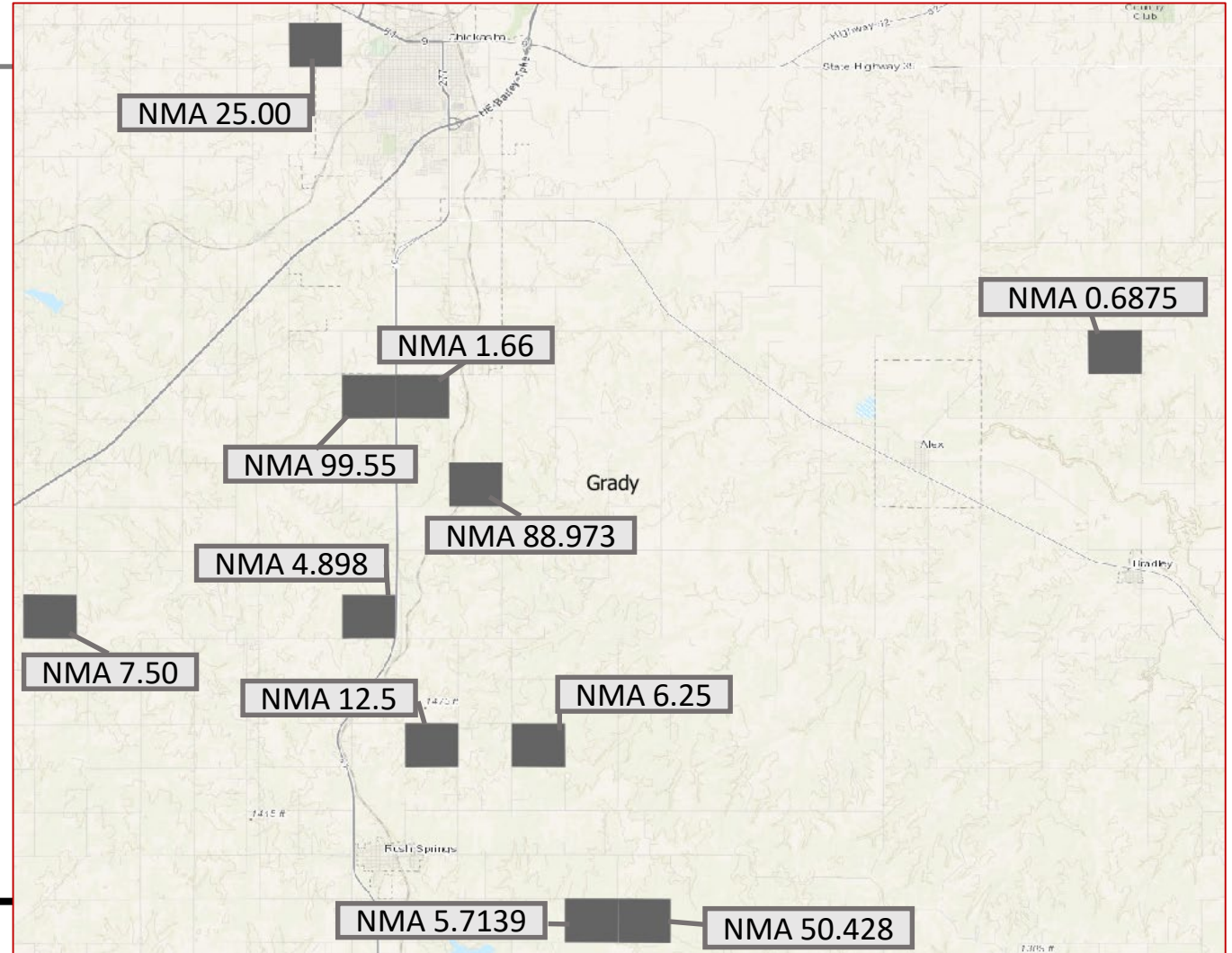

# Lockmar Resources, LLC

Cleveland & McClain Counties, Oklahoma

The Oil & Gas Asset Clearinghouse is partnering with Lockmar Resources, LLC to market leasehold acreage in Cleveland and McClain Counties, Oklahoma. Majority of leases with 80% NRI (minimum 78%)

## Group C Highlights

- 48.77 Total Net Mineral Acres
- Multiple targeted reservoirs-Mississippian, Woodford, Hunton
- Operators in the area: EOG Resources, Chesapeake, Charter Oak Production Co., Samson Resources, Northwest Oil Company

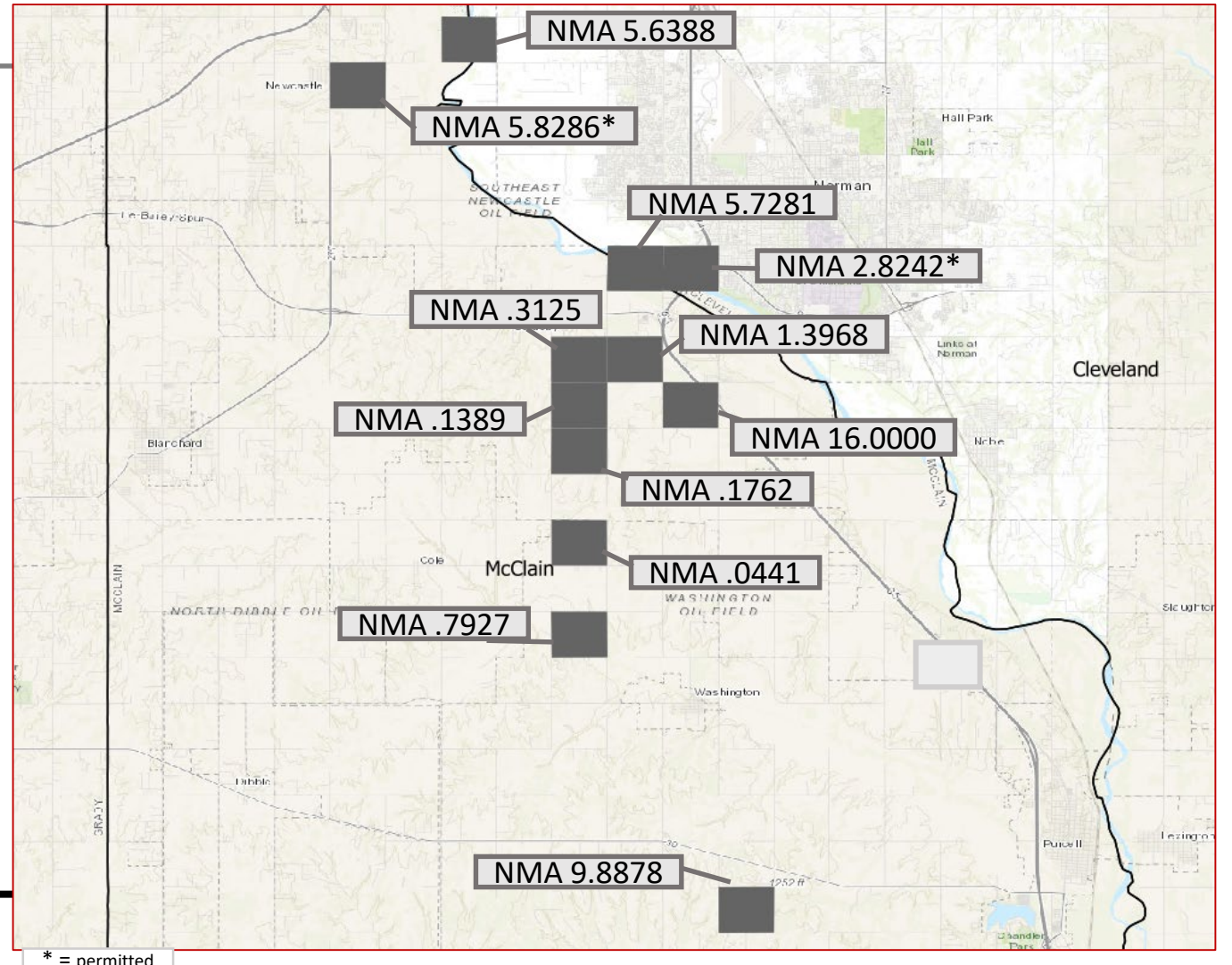



# Lockmar Resources, LLC

McClain & Garvin Counties, Oklahoma

The Oil & Gas Asset Clearinghouse is partnering with Lockmar Resources, LLC to market leasehold acreage in Dewey, Ellis, and Woodward Counties, Oklahoma. Majority leases 80% Net Revenue Interest.

## Group D Highlights

- 198.72 Total Net Mineral Acres
- Multiple targeted reservoirs-  
Mississippian, Woodford, Hunton
- Operators in the area: Chevron, EOG Resources, BP, Anadarko Petroleum, Exxon Mobil, Marathon Oil, Encana, Noble Energy, Devon Energy

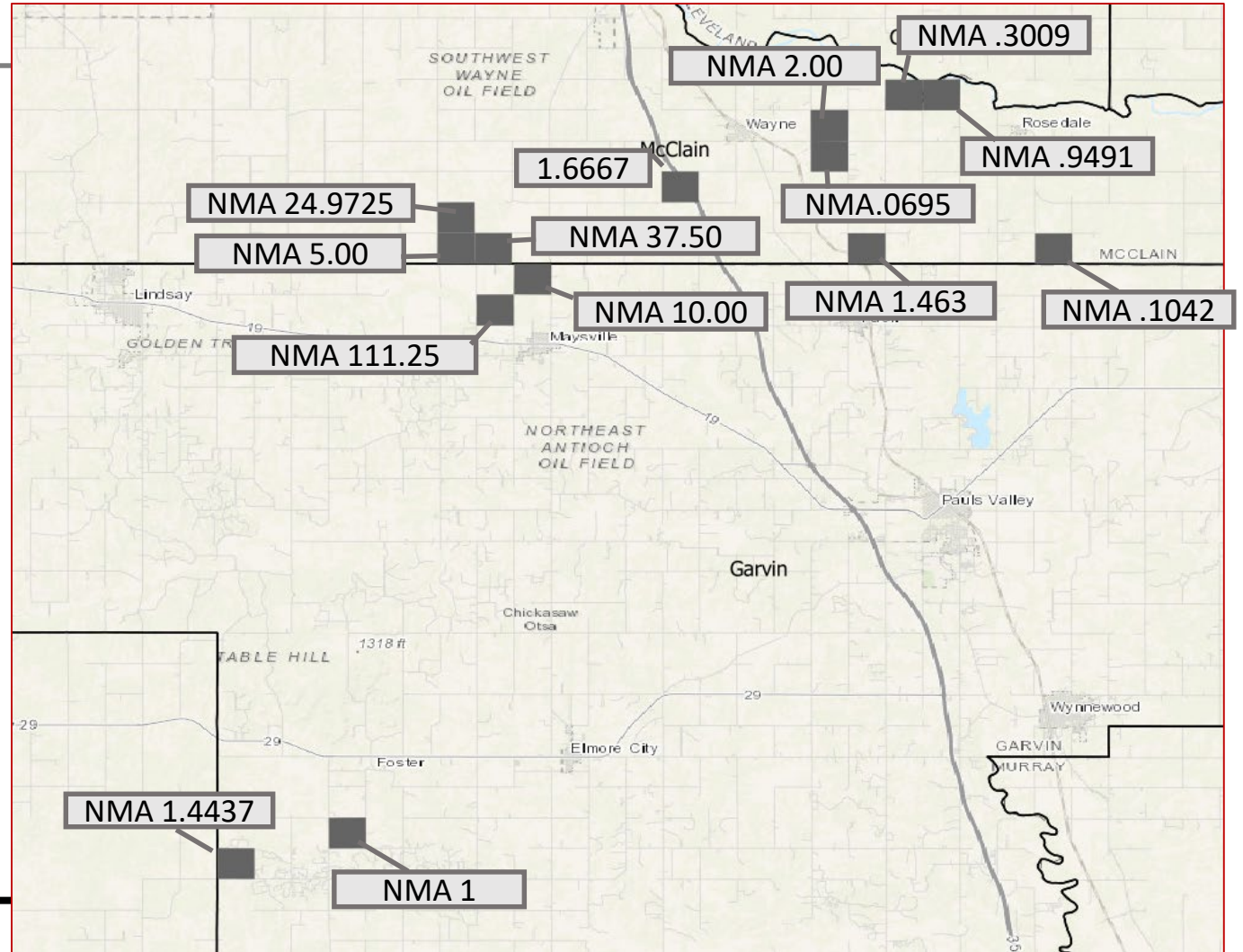



# Lockmar Resources, LLC

Stephens County, Oklahoma

The Oil & Gas Asset Clearinghouse is partnering with Lockmar Resources, LLC to market leasehold acreage in Stephens County Oklahoma. All leases 79% Net Revenue Interest.

## Group E Highlights

- Total 48.30 Net Mineral Acres
- Operators in the area: Roan Resources and Marathon

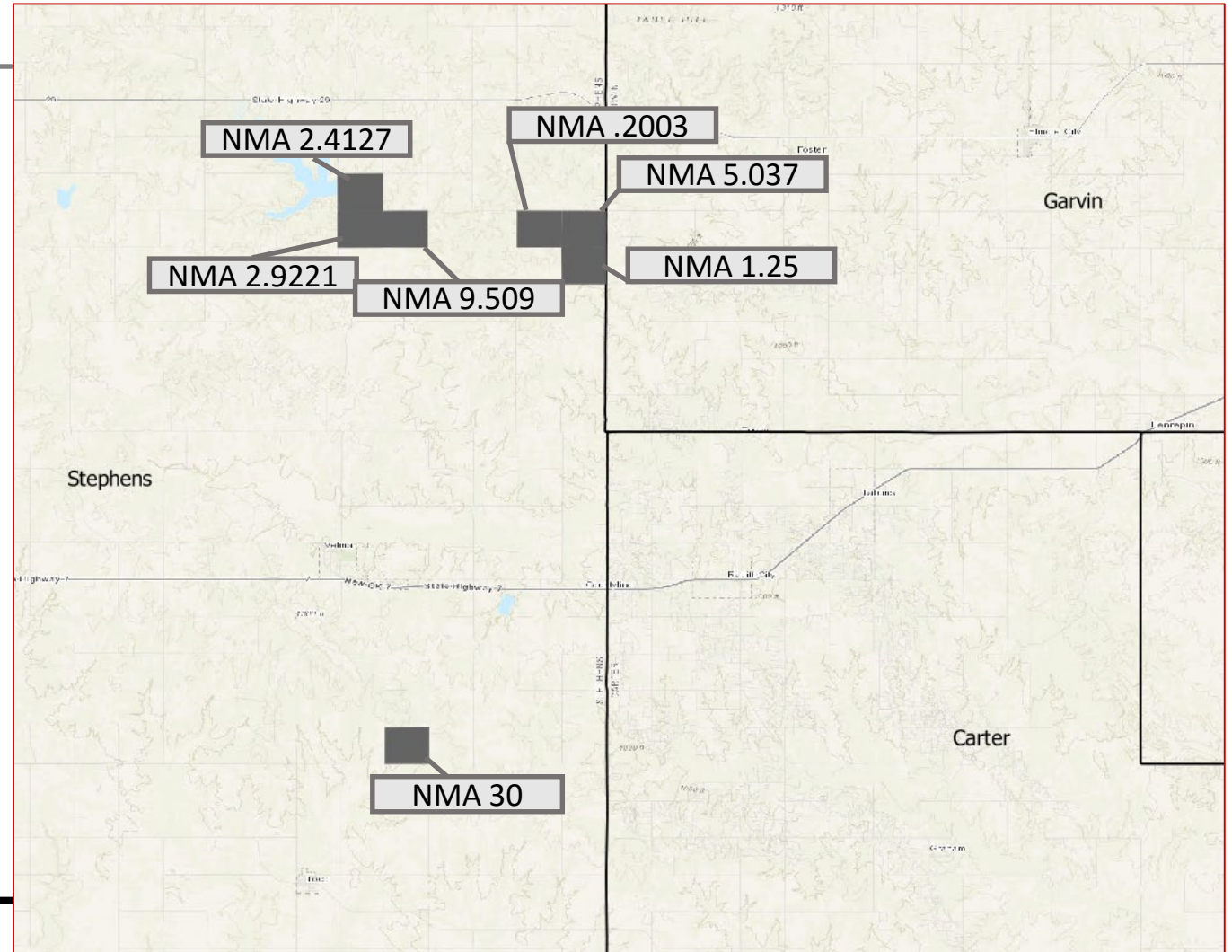

# Lockmar Resources, LLC

Dewey, Ellis, and Woodward Counties, Oklahoma

The Oil & Gas Asset Clearinghouse is partnering with Lockmar Resources, LLC to market leasehold acreage in Dewey, Ellis, and Woodward Counties, Oklahoma. All leases 80% Net Revenue Interest.

## Group F Highlights

- 348.12 Total Net Mineral Acres
- Multiple targeted reservoirs-  
Mississippian, Woodford, Hunton
- Operators in the area: White Star  
Petroleum, Mewbourne Oil Company,  
Tapstone Energy

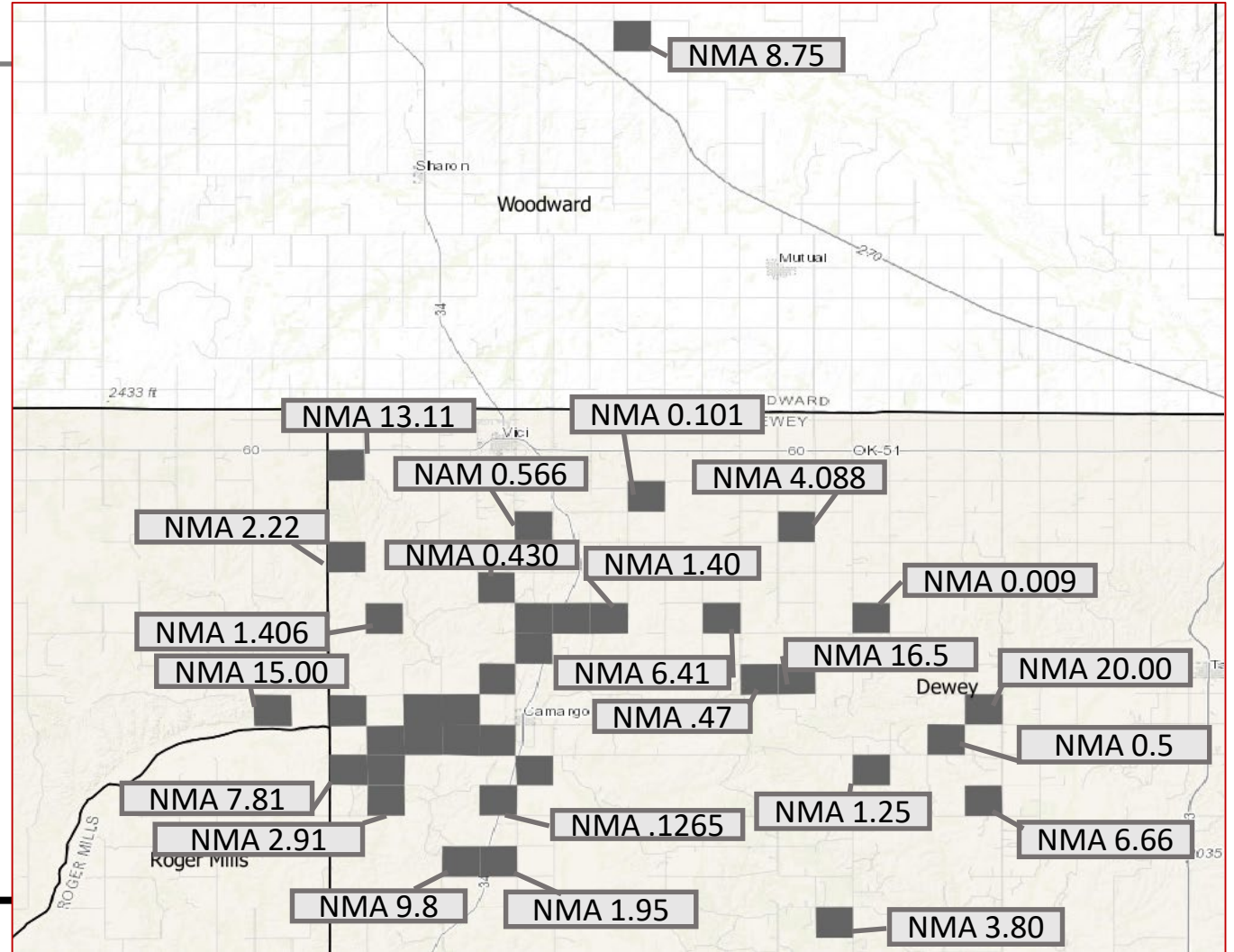

# Lockmar Resources, LLC

Dewey County, Oklahoma

The Oil & Gas Asset Clearinghouse is partnering with Lockmar Resources, LLC to market leasehold acreage in Dewey County, Oklahoma. All leases 80% Net Revenue Interest.

## Group G Highlights

- 347.01 Total Net Mineral Acres
- Multiple targeted reservoirs-  
Mississippian, Woodford, Hunton
- Operators in the area: White Star  
Petroleum, Mewbourne Oil Company,  
Tapstone Energy

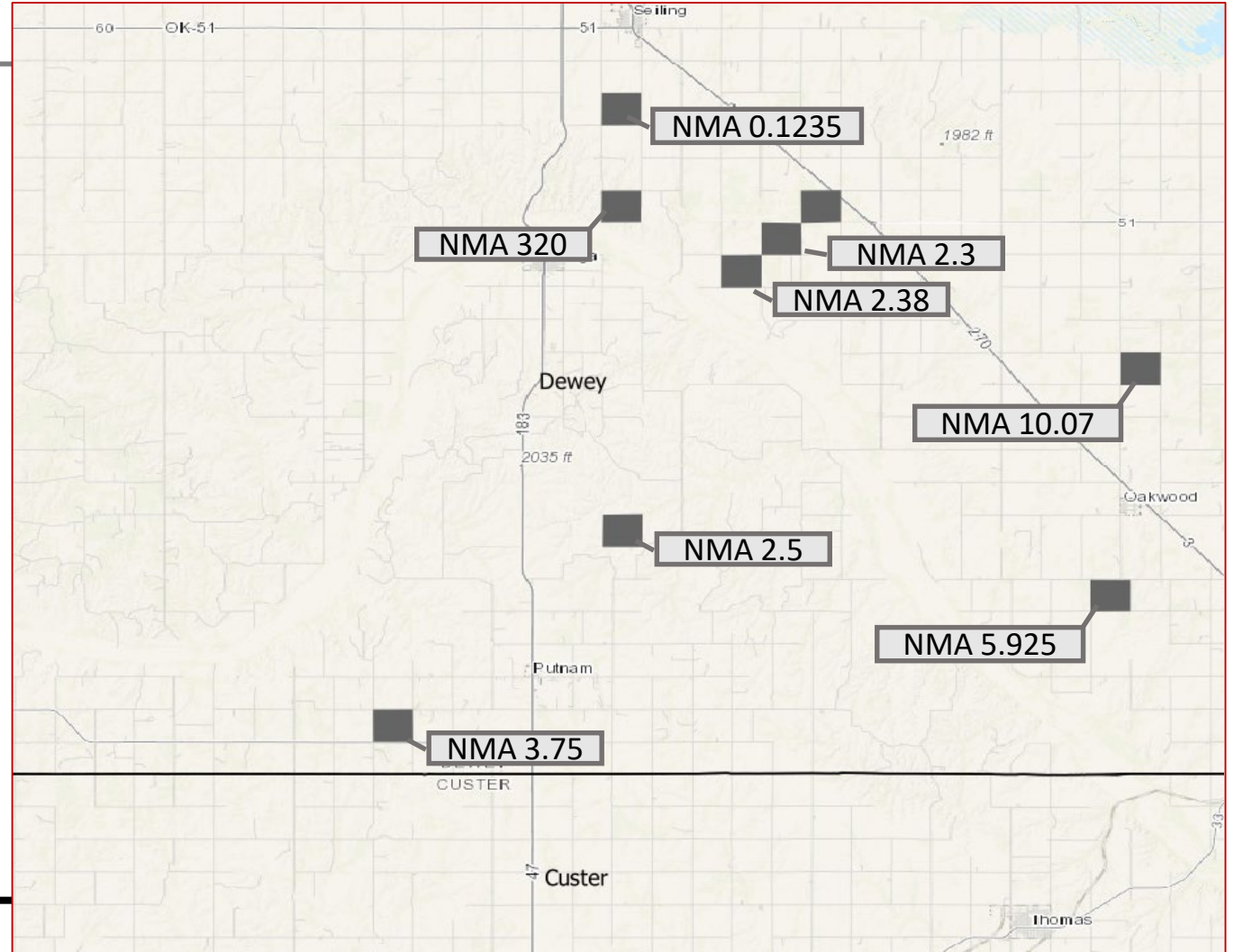



# Lockmar Resources, LLC

Custer County, Oklahoma

The Oil & Gas Asset Clearinghouse is partnering with Lockmar Resources, LLC to market leasehold acreage in Custer County, Oklahoma. All leases 80% Net Revenue Interest.

## Group H Highlights

- 7.54 Total Net Mineral Acres
- Multiple targeted reservoirs-  
Mississippian, Woodford, Hunton
- Operators in the area: White Star  
Petroleum, Mewbourne Oil Company,  
Tapstone Energy

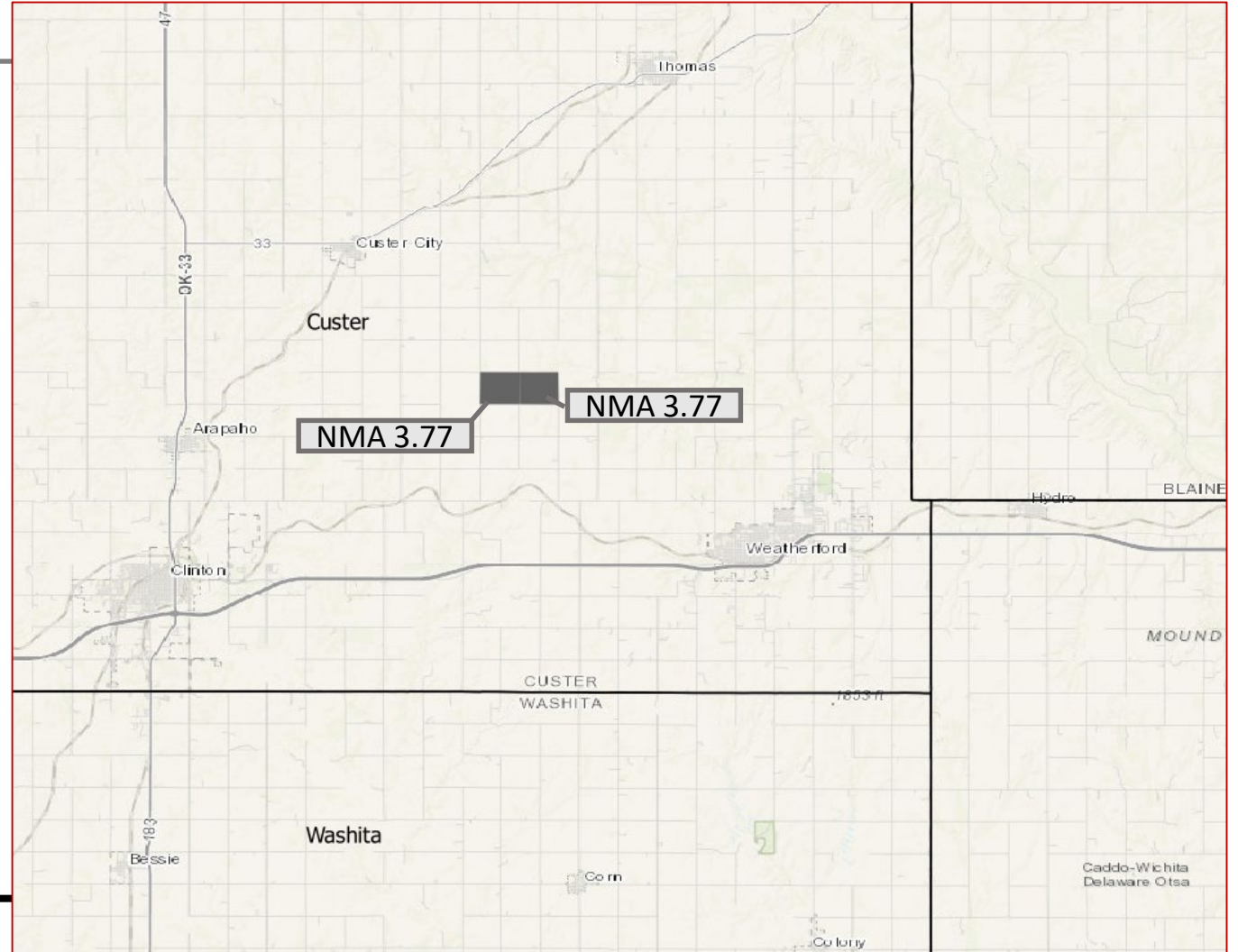

# Lockmar Resources, LLC

Blaine County, Oklahoma

The Oil & Gas Asset Clearinghouse is partnering with Lockmar Resources, LLC to market leasehold acreage in Blaine County, Oklahoma. All leases 79% Net Revenue Interest.

## Group I Highlights

- 40.25 Total Net Mineral Acres
- Multiple targeted reservoirs-Mississippian, Woodford, Hunton
- Operators in the area: White Star Petroleum, Mewbourne Oil Company, Tapstone Energy

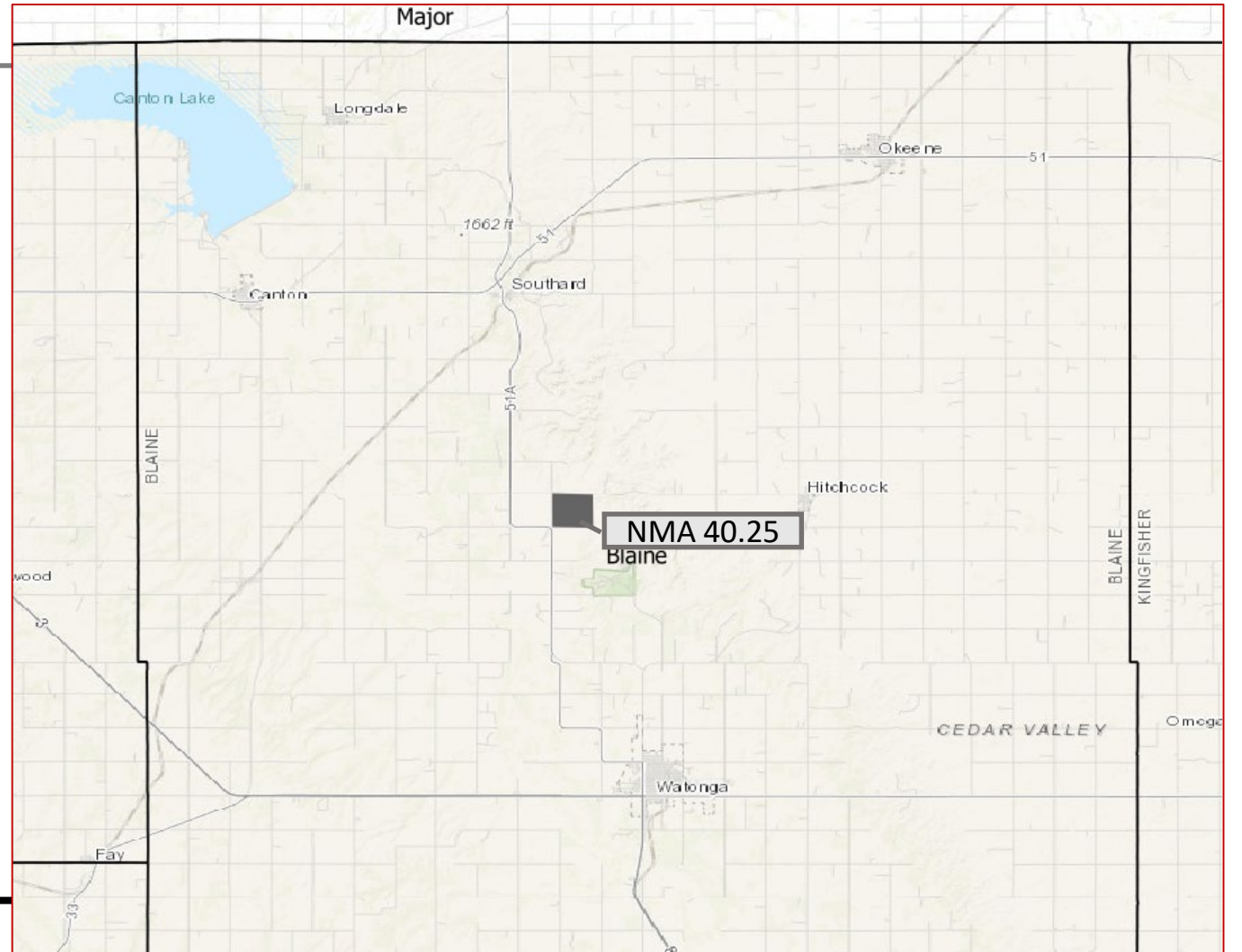

# Lockmar Resources, LLC

Major County, Oklahoma

The Oil & Gas Asset Clearinghouse is partnering with Lockmar Resources, LLC to market leasehold acreage in Major County, Oklahoma. All leases 80% Net Revenue Interest.

## Group J Highlights

- 32.34 Total Net Mineral Acres
- Multiple targeted reservoirs-  
Mississippian, Woodford, Hunton
- Operators in the area: White Star  
Petroleum, Mewbourne Oil Company,  
Tapstone Energy

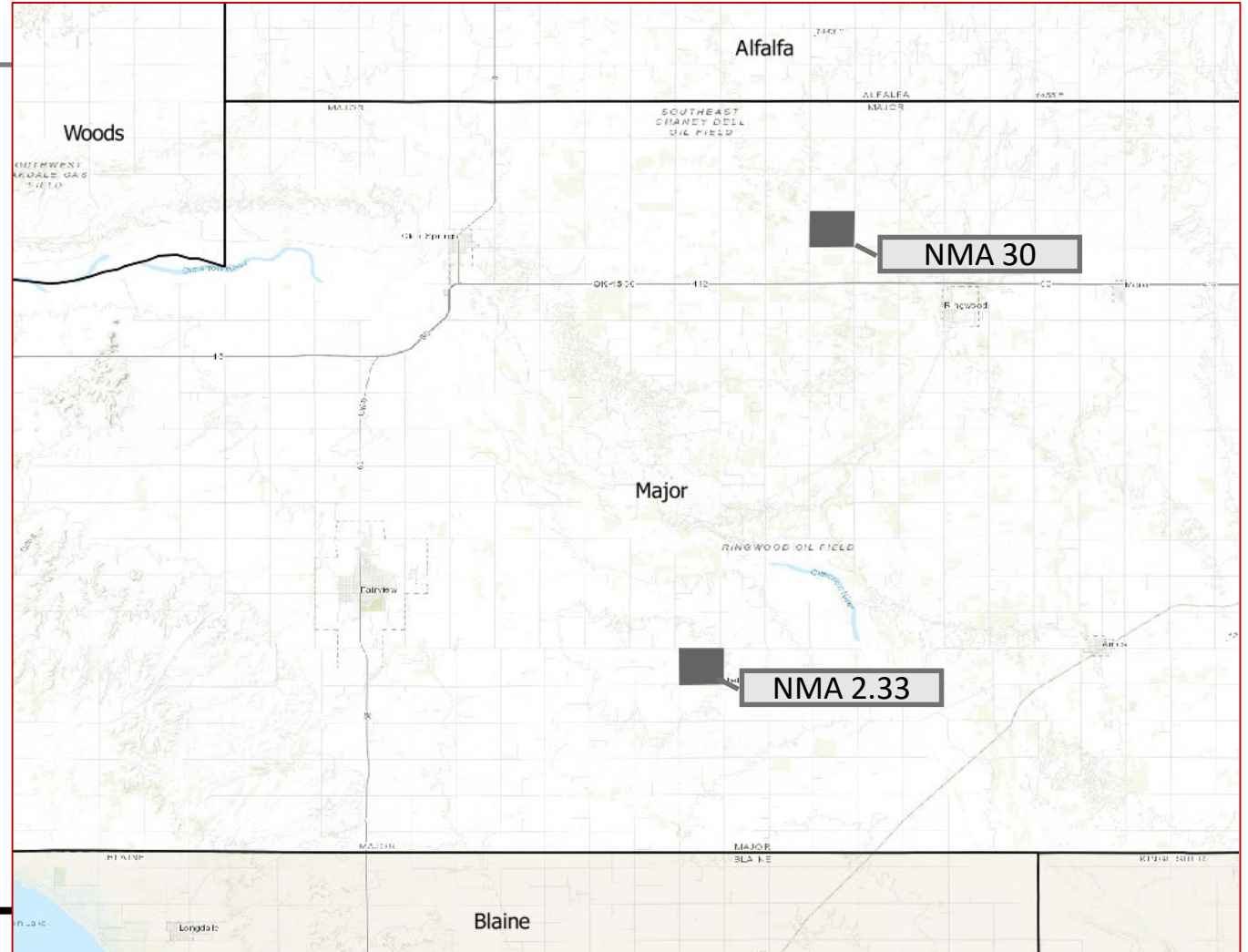



# Lockmar Resources, LLC

Caddo, Grady, McClain, Garvin, Stephens, Canadian, Dewey, Custer, Blaine, and Major Counties Oklahoma

## Sale Process

- Electronic Data Room Available October 29, 2019
- Bids Due November 21, 2019
- Single Group Bids Accepted (specify when bidding)

October							November						
M	T	W	Th	F	Sa	Su	M	T	W	Th	F	Sa	Su
	1	2	3	4	5	6					1	2	3
7	8	9	10	11	12	13	4	5	6	7	8	9	10
14	15	16	17	18	19	20	11	12	13	14	15	16	17
21	22	23	24	25	26	27	18	19	20	21	22	23	24
28	29	30	31				25	26	27	28	29	30	

 EDR Open  
 Bids Due

For additional questions or to obtain information, please contact our team:

<p><b>Matt DaPra</b> Business Development <a href="mailto:mdapra@ogclearinghouse.com">mdapra@ogclearinghouse.com</a> (719) 277-7923</p>	<p><b>John Herring</b> Petroleum Engineer <a href="mailto:jherring@ogclearinghouse.com">jherring@ogclearinghouse.com</a> (30) 829-1956</p>
---	--

## Oil & Gas Asset Clearinghouse

1235 North Loop West, Ste 510  
Houston, Texas 77003  
Phone: (281) 873-4600

Lockmar Resources, LLC ("Company") is selling certain leasehold assets in multiple Counties in the State of Oklahoma. Oil & Gas Asset Clearinghouse, LLC ("Clearinghouse") is the exclusive technical, marketing, and transaction advisor for this sale. The Company and Clearinghouse make no representations or warranties, either express or implied, as to the accuracy or completeness of this information or its suitability for any purpose. The sales process contemplated herein is not exclusive. The Company and Clearinghouse reserve the right to withdraw all or any portion of the assets or change all or any terms of this sales process at any time without notice to any potential purchaser.