



Colorado Non-Producing Leasehold Acreage

Weld and Larimer Counties, CO

SEALED BID PROCESS

Weld and Larimer
Counties, CO

Wattenberg Field

Niobrara and Codell
productive area

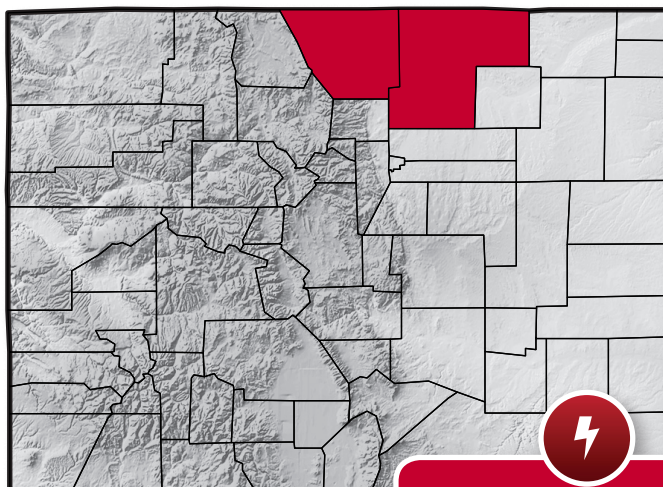

**Currently
Accepting Offers**

OPPORTUNITY HIGHLIGHTS

- 429.58 total non-producing leasehold net mineral acres
- Horizontal well play with extended reach horizontals
- Offset operators include:
 - Noble Energy
 - PDC Energy
 - Kerr-McGee Oil & Gas
 - Extraction Oil & Gas LLC
 - Bonanza Creek Energy
 - Whiting Oil & Gas
 - Synergy Resources Corp.
 - Bayswater E&P LLC
 - Great Western Operating Co.

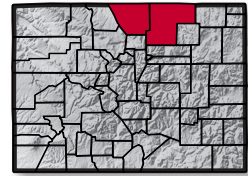

Weld and Larimer Counties, CO

OIL & GAS ASSET CLEARINGHOUSE

Wattenberg Field
Weld and Larimer Counties, CO
429.58 total non-producing leasehold net mineral acres

Weld and Larimer Counties Overall Acreage Swan Energy Colorado Non-Producing Leasehold Acreage Package

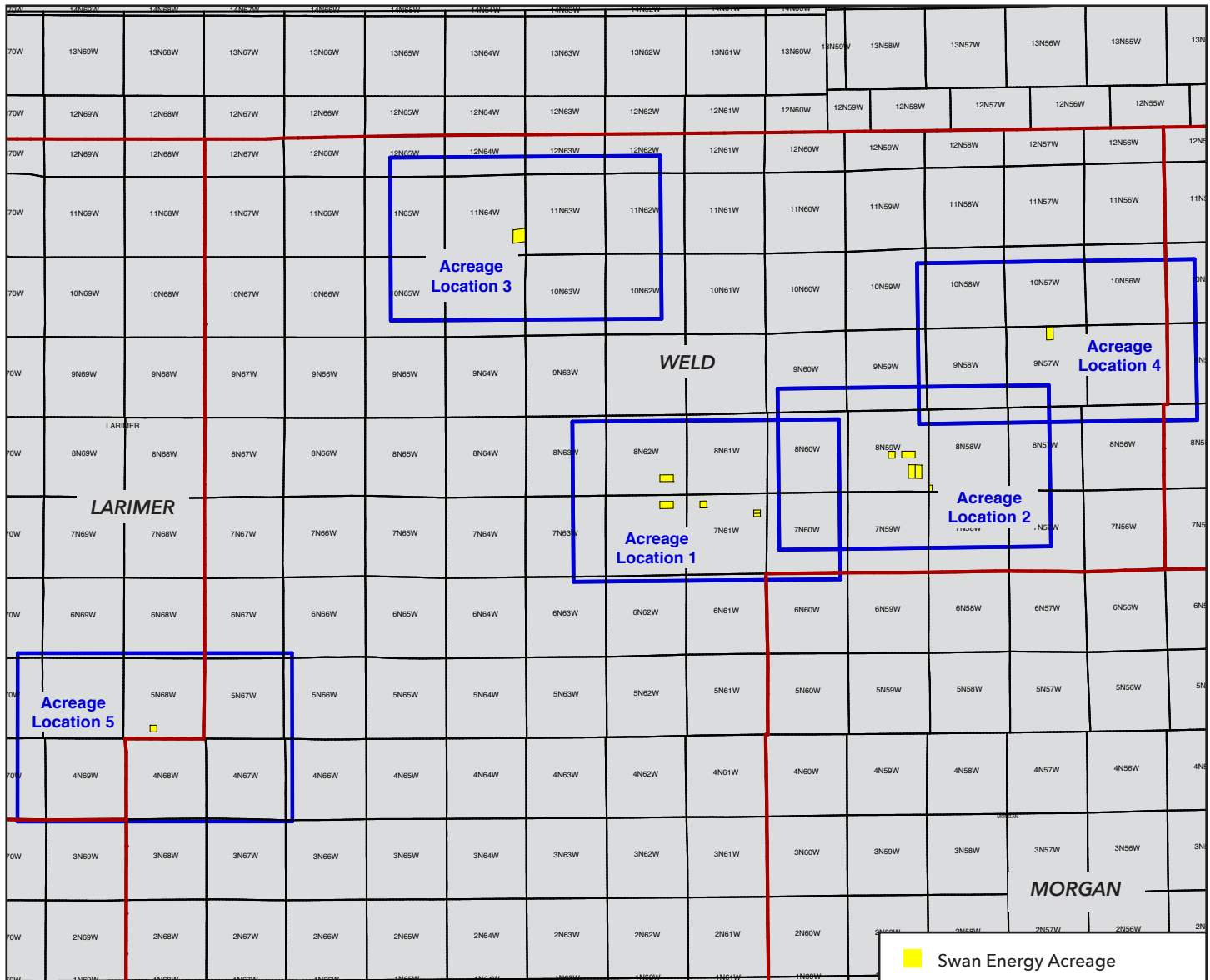

OIL & GAS ASSET CLEARINGHOUSE

Wattenberg Field
Weld County

255.65 total non-producing
leasehold net mineral acres

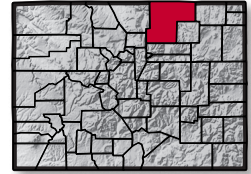

Weld County, CO

Weld County Acreage Location (1 of 4) Swan Energy Colorado Non-Producing Leasehold Acreage Package

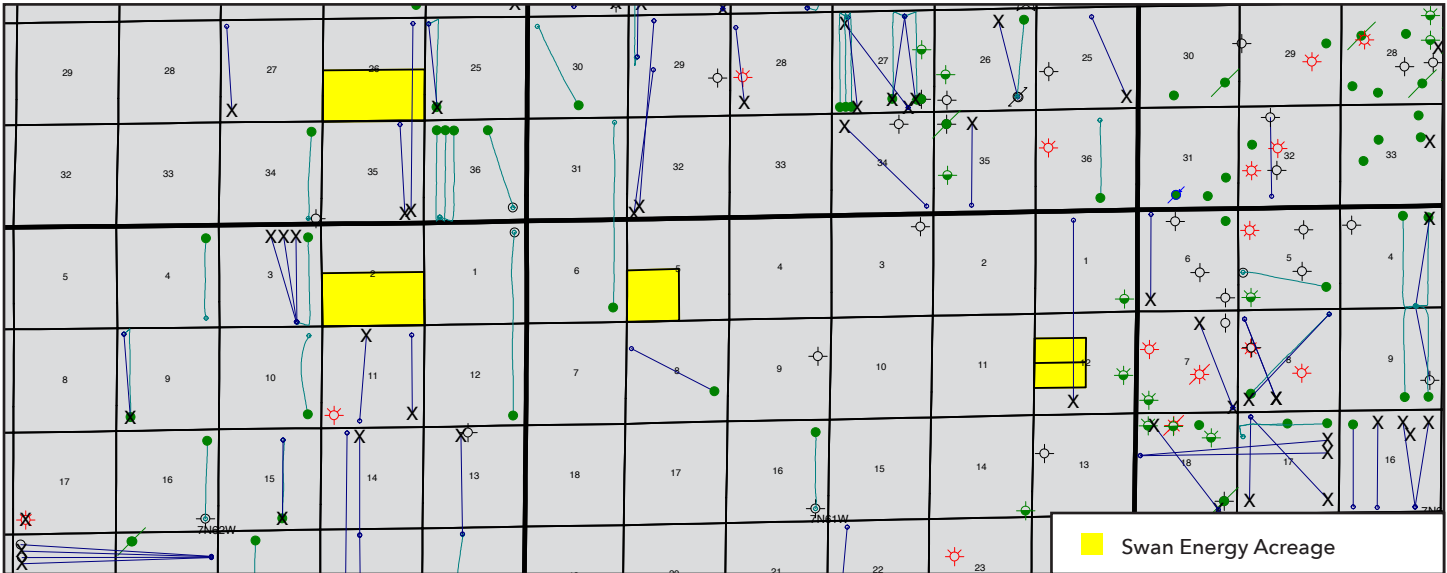

Weld County Offset Operators (Location 1 of 4) Swan Energy Colorado Non-Producing Leasehold Acreage Package

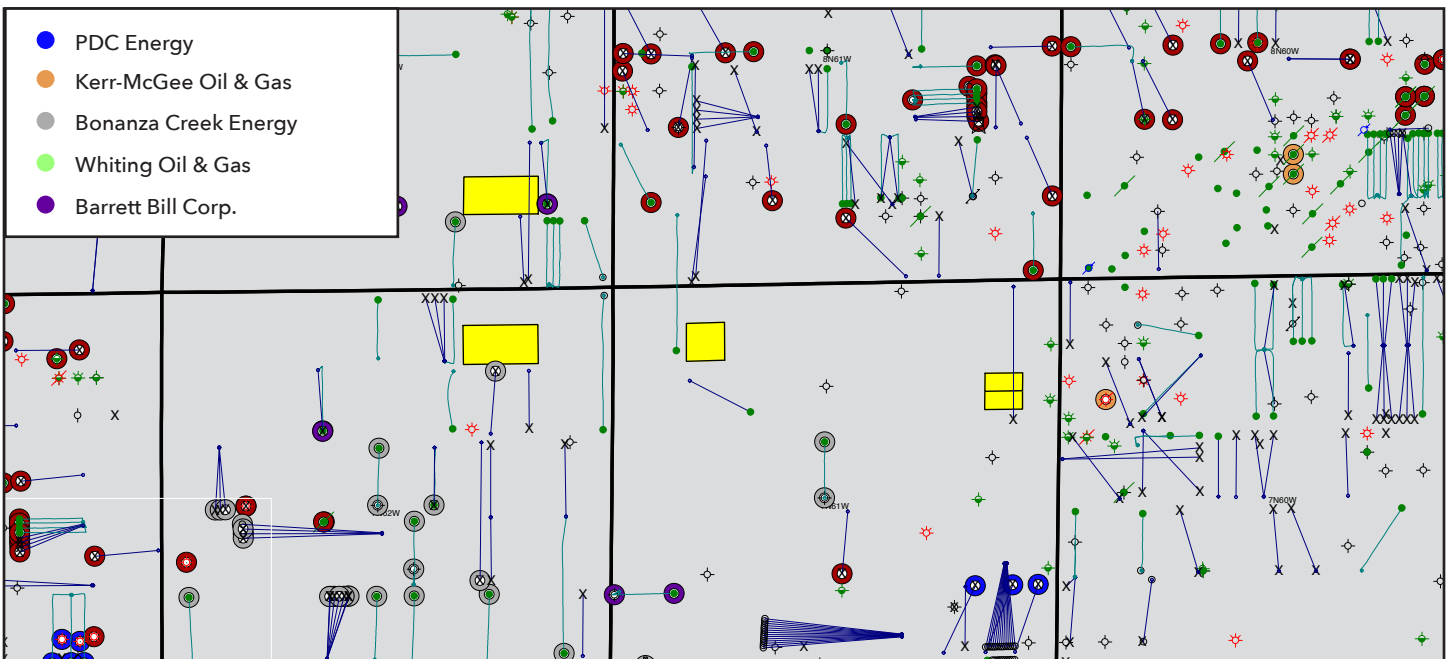

OIL & GAS ASSET **CLEARINGHOUSE**

Wattenberg Field
Weld County, CO

28.38 total non-producing
leasehold net mineral acres

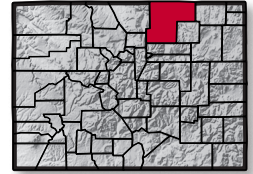

Weld County, CO

Weld County Acreage Location (2 of 4) Swan Energy Colorado Non-Producing Leasehold Acreage Package

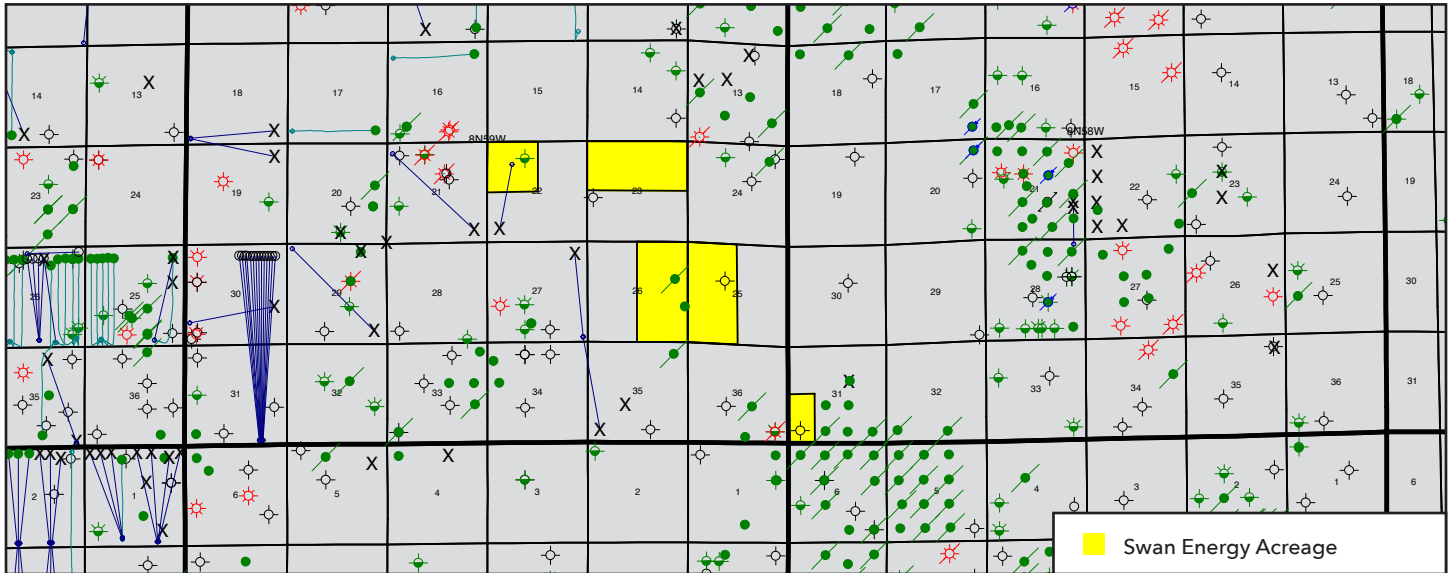

Weld County Offset Operators (Location 2 of 4) Swan Energy Colorado Non-Producing Leasehold Acreage Package

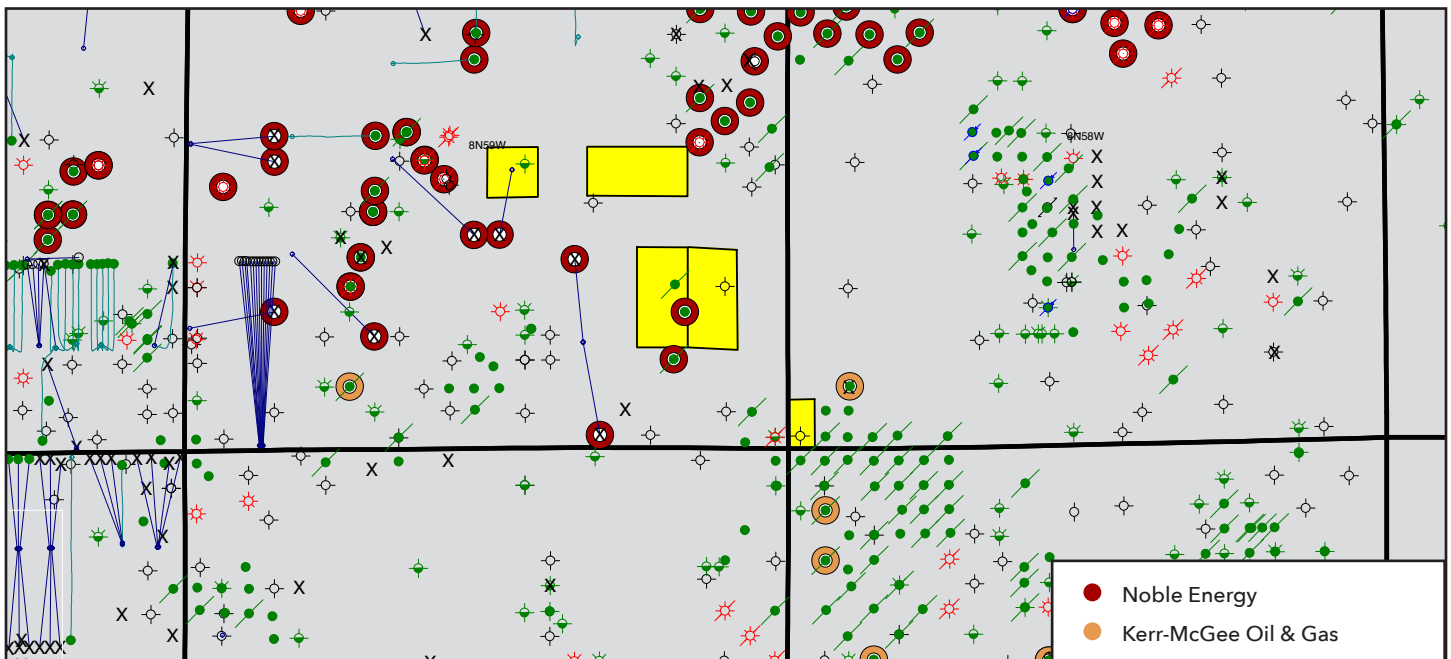

OIL & GAS ASSET **CLEARINGHOUSE**

Wattenberg Field
Weld County, CO

64.00 total non-producing
leasehold net mineral acres

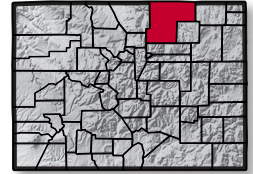

Weld County, CO

Weld County Acreage Location (3 of 4) Swan Energy Colorado Non-Producing Leasehold Acreage Package

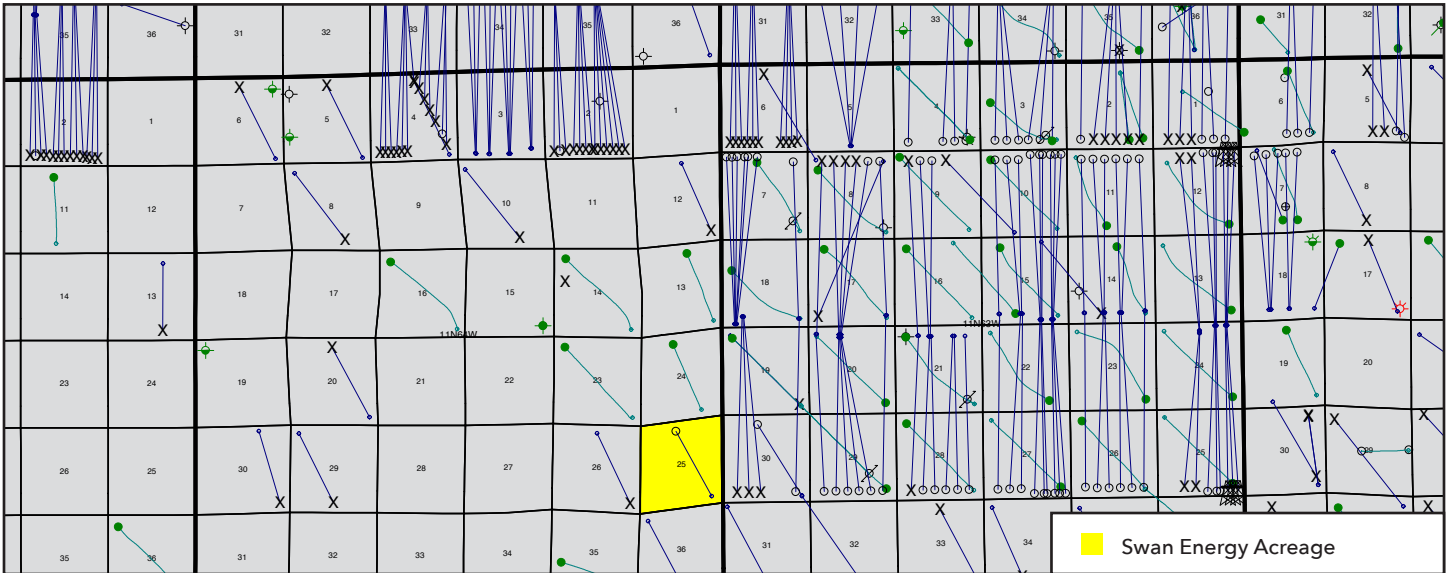

Weld County Offset Operators (Location 3 of 4) Swan Energy Colorado Non-Producing Leasehold Acreage Package

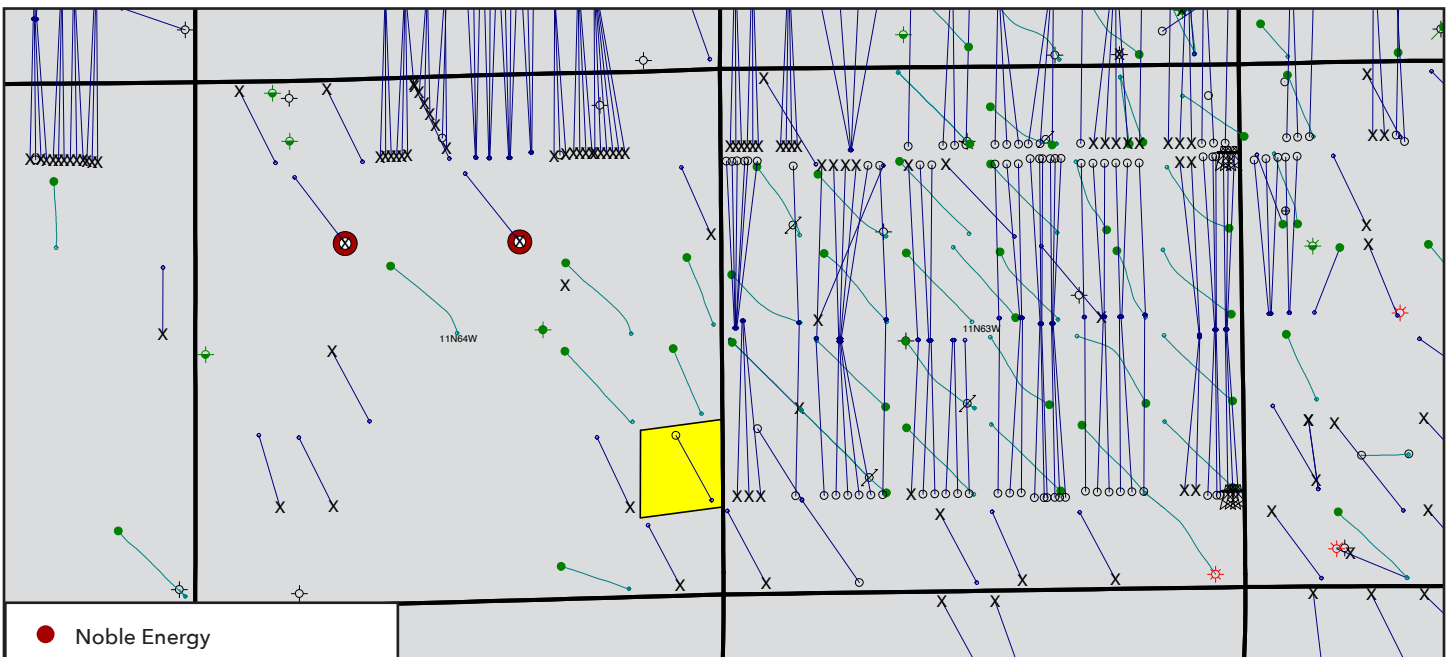

OIL & GAS ASSET CLEARINGHOUSE

Wattenberg Field
Weld County, CO

80.40 total non-producing
leasehold net mineral acres

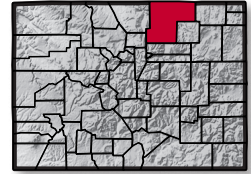

Weld County, CO

Weld County Acreage Location (4 of 4) Swan Energy Colorado Non-Producing Leasehold Acreage Package

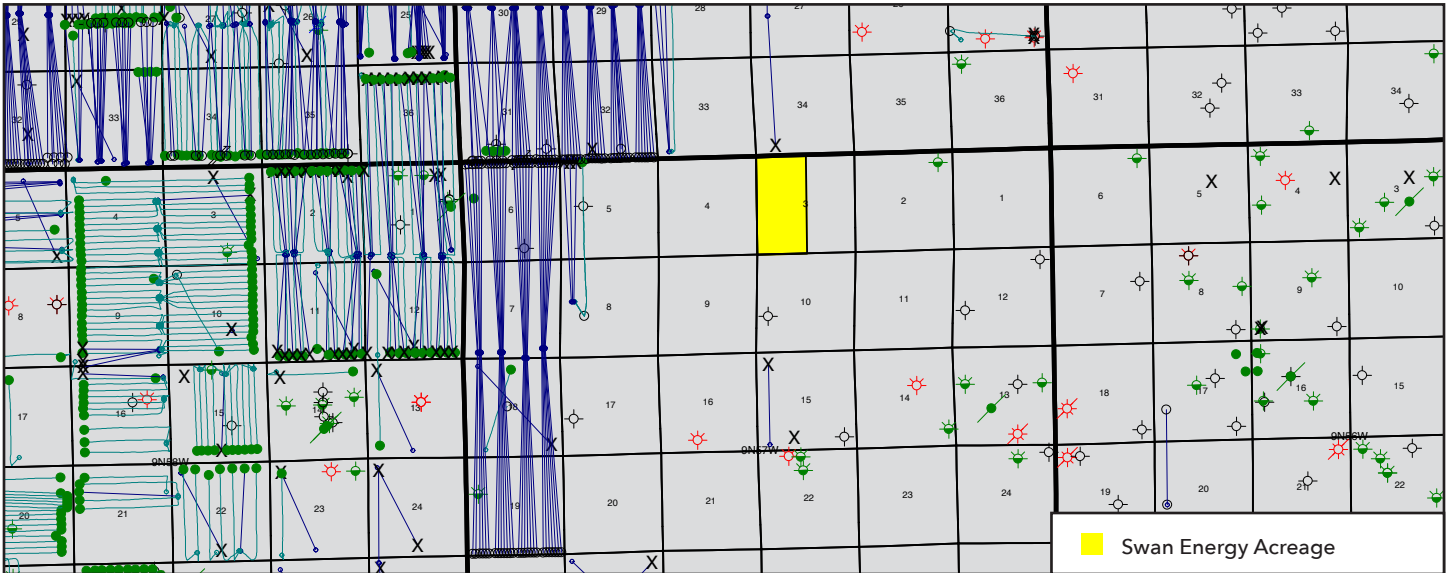

Weld County Offset Operators (Location 4 of 4) Swan Energy Colorado Non-Producing Leasehold Acreage Package

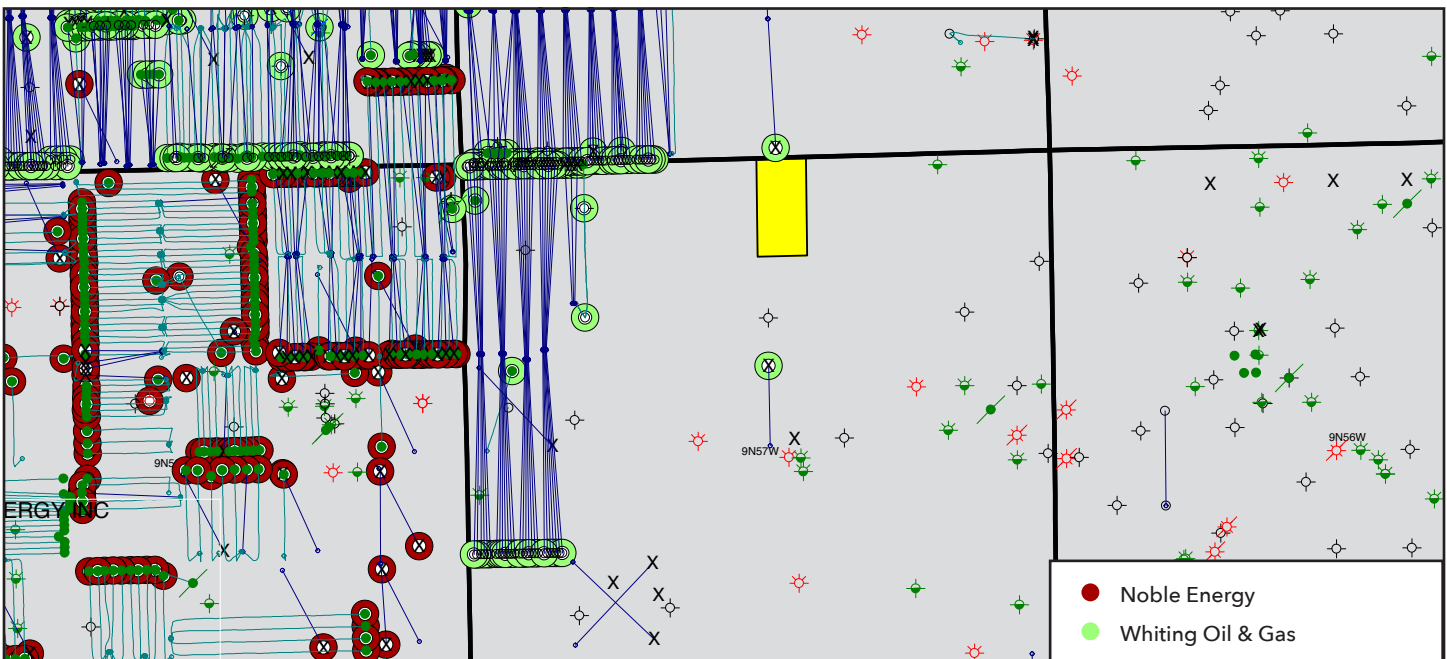

OIL & GAS ASSET CLEARINGHOUSE

Wattenberg Field
Larimer County, CO

4.52 total non-producing
leasehold net mineral acres

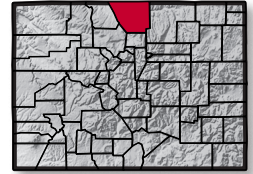

Larimer County, CO

Larimer County Acreage Location Swan Energy Colorado Non-Producing Leasehold Acreage Package

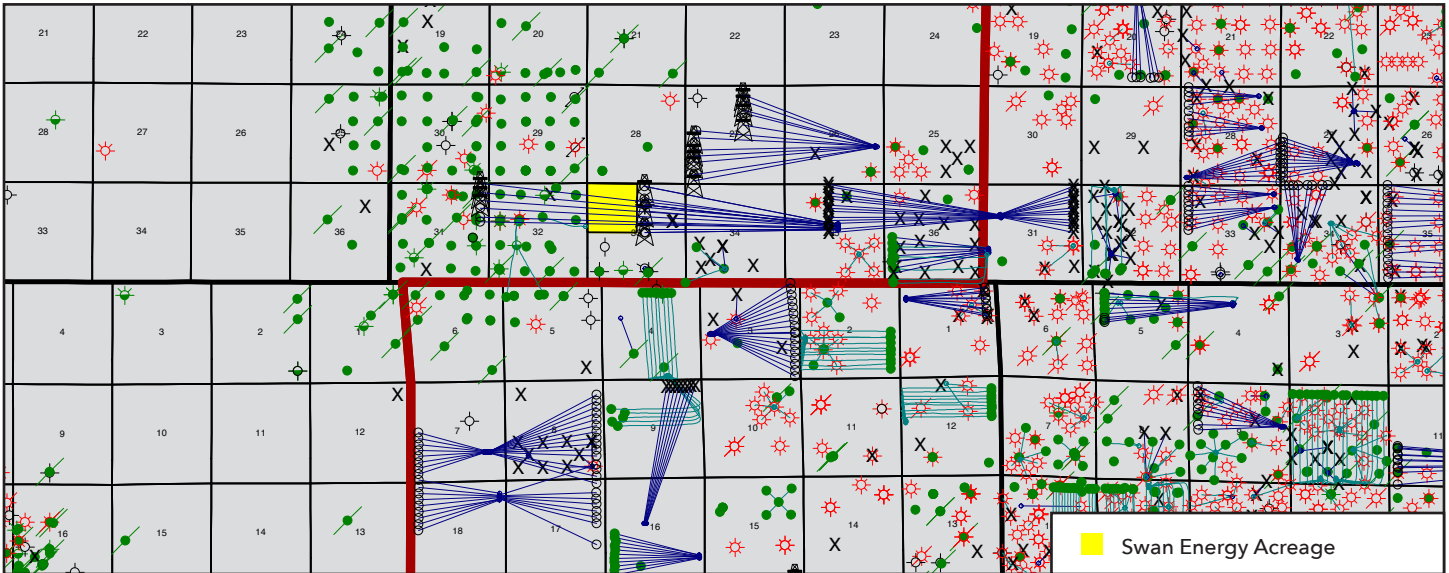

Larimer County Offset Operators Swan Energy Colorado Non-Producing Leasehold Acreage Package

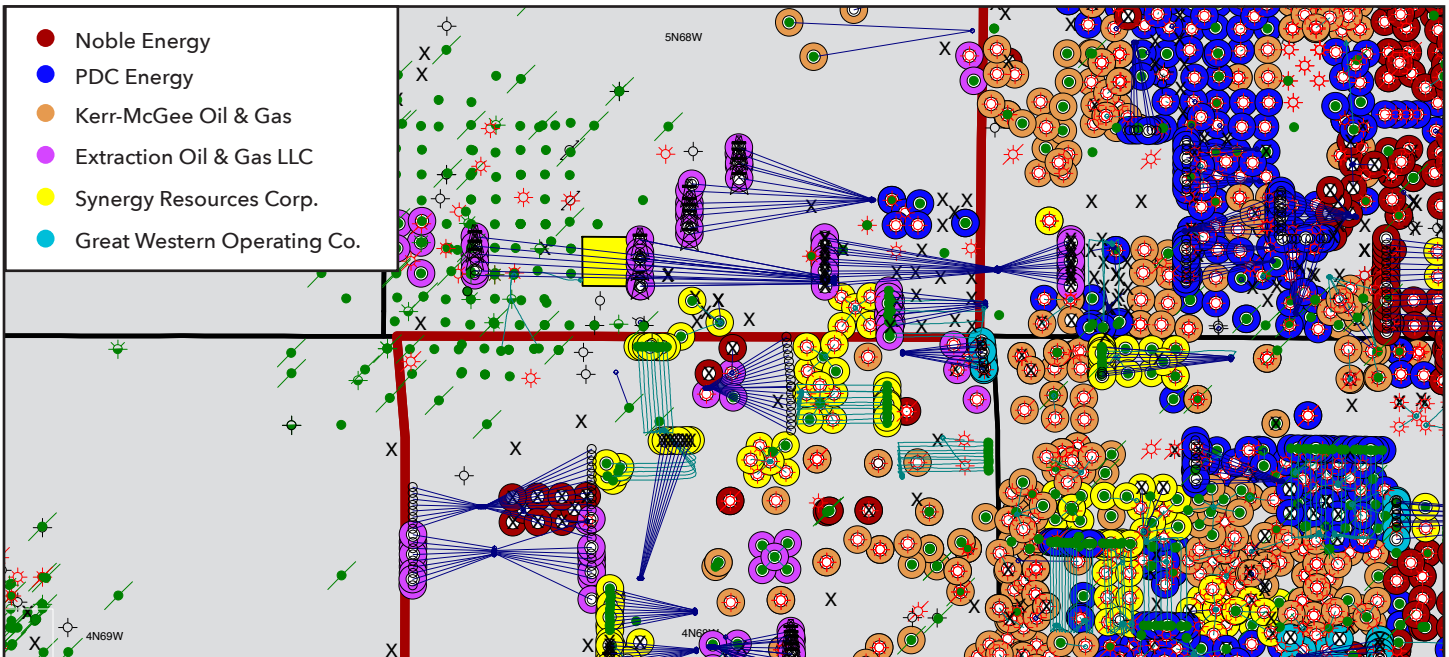



Colorado Non-Producing Leasehold Acreage

Weld and Larimer Counties, CO

Evaluation Data Available at



a.m.p.

Asset Marketing Platform

Data Room Now Open at
www.ogclearinghouse.com

Currently Accepting Offers

Business Development and Negotiations Team

Patrick DaPra

Vice President - Negotiated Transactions
pdapra@ogclearinghouse.com
(832) 601-7655

Amanda Novak

Business Development
Houston
anovak@ogclearinghouse.com
(832) 601-7614

Matt DaPra

Manager - Business Development
Midland
mdapra@ogclearinghouse.com
(713) 277-7923

Deon Warner

President
dwarner@ogclearinghouse.com
(281) 873-4600

Contact Clearinghouse:

Patrick DaPra

VP - Negotiated Transactions
pdapra@ogclearinghouse.com
(832) 601-7655

Amanda Novak

Business Development
Houston
anovak@ogclearinghouse.com
(832) 601-7614

Swan Energy, LLC ("Company") is selling certain leasehold assets in Weld and Larimer Counties, Colorado. Oil & Gas Asset Clearinghouse, LLC ("Clearinghouse") is the exclusive technical, marketing, and transaction advisor for this sale.

The Company and Clearinghouse make no representations or warranties, either expressed or implied, as to the accuracy or completeness of this information or its suitability for any purpose. The sales process contemplated herein is not exclusive. The Company and Clearinghouse reserve the right to withdraw all or any portion of the assets or change all or any terms of this sales process at any time without notice to any potential purchaser.

OIL & GAS ASSET **CLEARINGHOUSE**

Oil & Gas Asset Clearinghouse, LLC

1235 North Loop West, Suite 510
Houston, TX 77008
(281) 873-4600

Clearinghouse has participated in the sale of over \$13.2 billion of assets. We market operated and non-operated producing working interests, overrides, royalties, minerals and non-producing leaseholds to our database of over 20,000 registered and approved buyers and sellers.